

B
C134

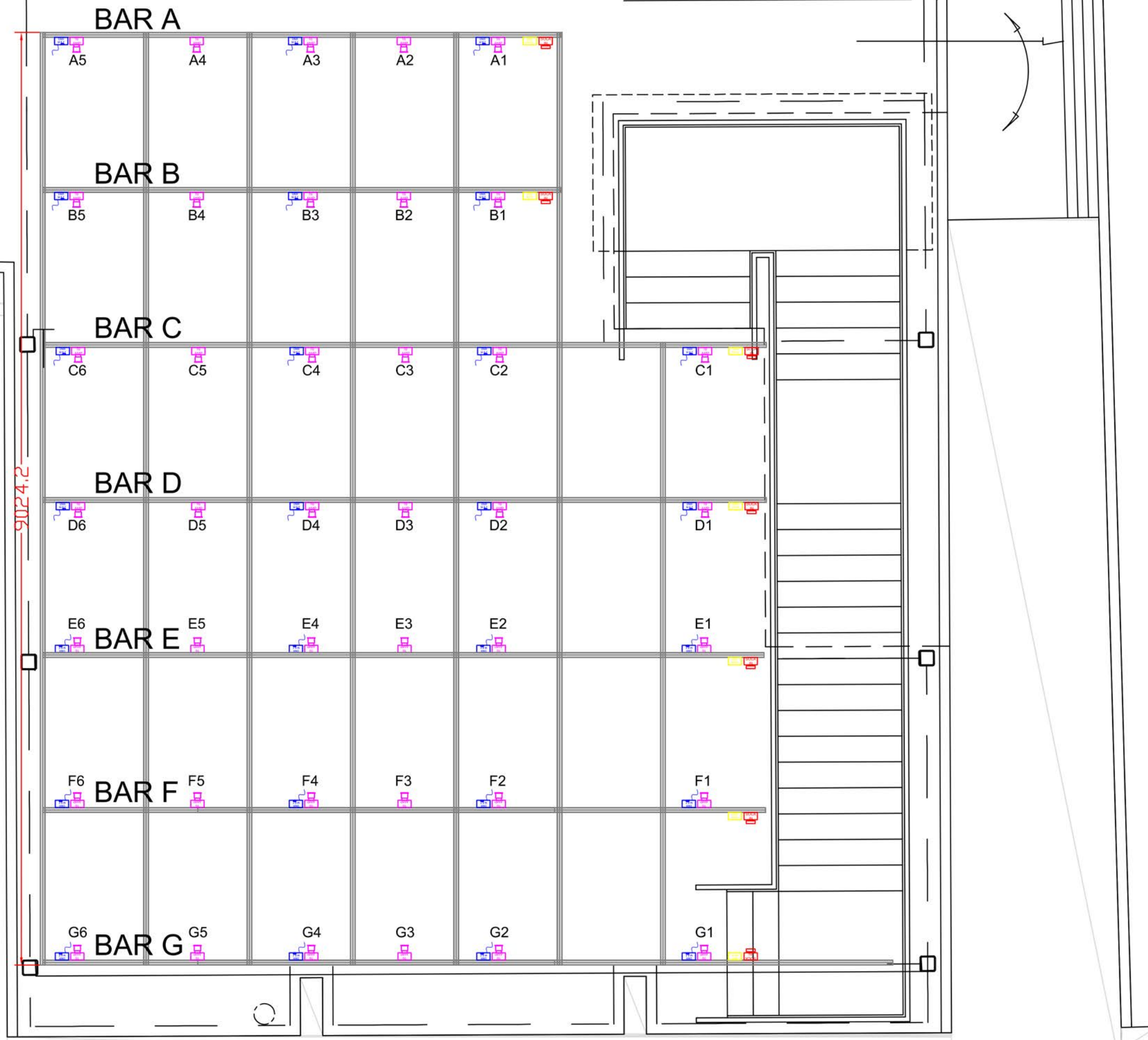

THIRD ANGLE PROJECTION
ALL DIMS IN MM
DO NOT SCALE
IF IN DOUBT ASK

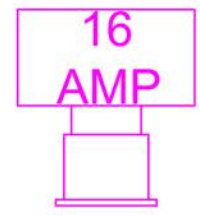

16A CEE
Sockets

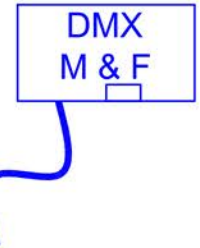

1 off XLR5F panel connector and 1 off XLR5M line connector on a short tail



1 off XLR5M panel connector



Male Socapex inlet connector

REVISED	NOTES	DATE	APPROVED BY	DATE
4/11/2016				
DESIGNED BY	PAT	START DATE	4/11/2016	SHEET 1/2
White Light 20 Merton Industrial Park Jubilee Way London SW19 3BJ tel: +44 (0)20 8254 4800 fax: +44 (0)20 8254 4801 email: Projects@WhiteLight.Ltd.uk internet: www.WhiteLight.Ltd.uk				
CUSTOMER				
SPANISH THEATRE COMPANY				
PROJECT				
SPANISH THEATRE				
PROJECT No.				
100-071338				
DRAWING TITLE				
GRID LAYOUT				
SCALE	PART No./ DRAWING No.	REV		
1:NTS	71338-1	-		

© WHITE LIGHT LTD 2016
This document is COPYRIGHT and the property of White Light Ltd.
It must not be copied (in whole or in part), used for manufacture or otherwise disclosed without the written consent of the company.
Any copies of this document made by any method must include a copy of this legend.

THIRD ANGLE PROJECTION
ALL DIMS IN MM
DO NOT SCALE
IF IN DOUBT ASK

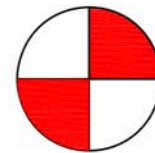

Grid suspension point. Lindapter Flange Clamp and M12 Threaded bar

Loadings:
25kgs per metre to a maximum grid load of 1150kgs

C134

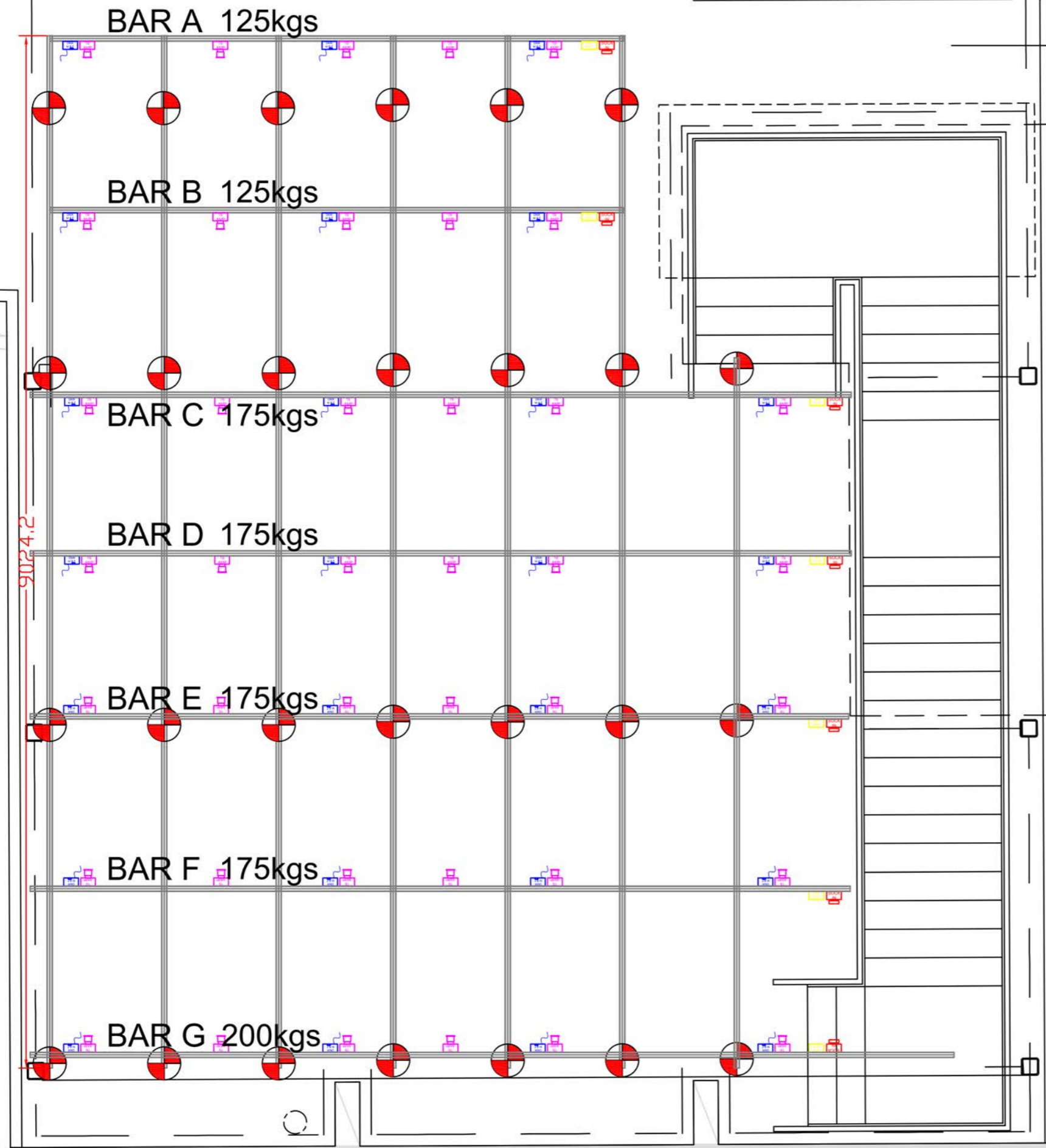

REVISED	NOTES	APPROVED BY	DATE
-	-	-	-
-	-	-	-
-	-	-	-
4/11/2016		MS	APP BY
DESIGNED BY	PAT	START DATE	4/11/2016
		SHEET	2/2

White Light
20 Merton Industrial Park
Jubilee Way
London
SW19 3BJ
tel: +44 (0)20 8254 4800
fax: +44 (0)20 8254 4801
email: Projects@WhiteLight.Ltd.uk
internet: www.WhiteLight.Ltd.uk

CUSTOMER
SPANISH THEATRE COMPANY

PROJECT
SPANISH THEATRE

PROJECT No.
100-071338

DRAWING TITLE
GRID LOADING LAYOUT

SCALE	PART No./ DRAWING No.	REV
1:NTS	71338-2	-

© WHITE LIGHT LTD 2016
This document is COPYRIGHT and the property of White Light Ltd.
It must not be copied (in whole or in part), used for manufacture or
otherwise disclosed without the written consent of the company.
Any copies of this document made by any method must include a copy of this legend.